

6	19935-02	POWER ACTUATOR MOUNT FASTENERS	2
5	15555-01	ASSEMBLY MOUNT FASTENER	3
4	20504-01	POWER LOCK ROD	1
3	19062-01	POWER ACTUATOR	1
2	20503-01	POWER MOUNTING BRACKET	1
1	19583-03, -04, -05, -06	BAGGAGE ASSEMBLY WITH PLASTIC PLUNGER	1
<b>RIGHT HAND 060-0475 PLASTIC PLUNGER WITH POWER LOCK</b>			

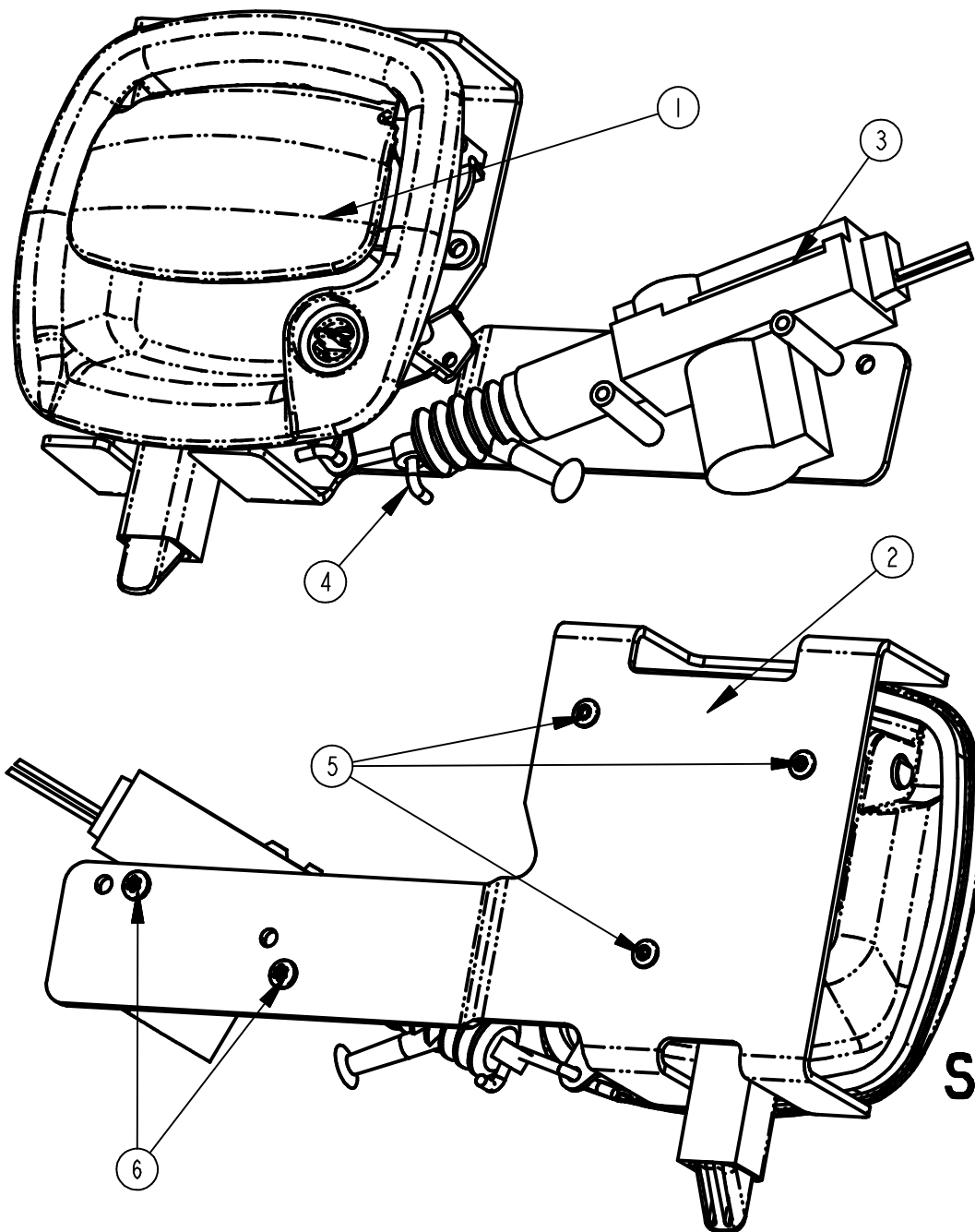

**SHEET 2 OF 7**

<b>DRAWN BY</b>	BJP	6/26/14
<b>CHKD BY</b>		
<b>RLSE DATE</b>		

<b>TYPICAL APPLICATION</b>	
MODEL TY060-0475	
<b>SCALE</b>	<b>DESCRIPTION</b>
0.500	060-0475, TYPICAL APPLICATIONS
<b>SIZE</b>	
<b>A</b>	
<b>REVISION</b>	<b>PART NUMBER</b>
	TY060-0475A